

RYTLE Softbox For TriLiner

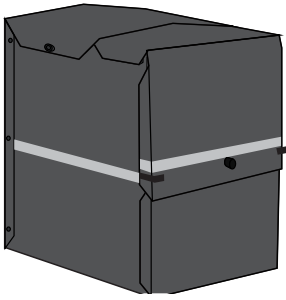

SOFTBOX Back

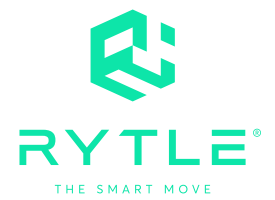
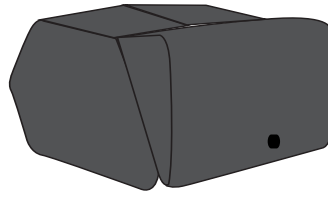

SOFTBOX Front

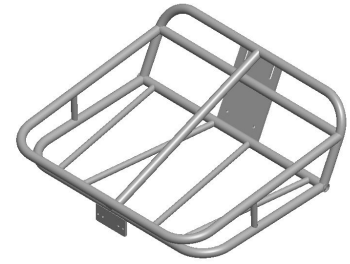

Load Carrier F21

Technical Description

SOFTBOXES for TriLiner Load Carrier F21 (SOFTBOX Front) and TriLiner loading platform with Quick & Easy-System (SOFTBOX Back)

2-layer-technology made of polypropylene and canvas, waterproof and easy to clean

Each SOFTBOX has a large side loading flap for loading and two lids for convenient removal of the load

Quick and safe access thanks to push-lock system on all loading flaps and lids

SOFTBOX Back: Shelf for box subdivision, battery compartment for additional exchangeable battery

2 x letter boxes in front and 6 x letter boxes in back can be loaded

SOFTBOXES in grey and blue, more colours on request

Optional: printing or labelling with customer logo

Technical Data

Type	SOFTBOX for TriLiner Back	Volume	0,460 m ³
Tare Weight	25 kg	Load	65 kg
Length	900 mm	Inner Length	835 mm
Width	670 mm	Inner Width	620 mm
Height	820 mm; 1,210 mm TriLiner with SOFTBOX	Inner Height	790 mm

Technical Data

Type	SOFTBOX for TriLiner Front	Volume	0,159 m ³
Tare Weight	4 kg	Load	25 kg
Length	590 mm	Inner Length	570 mm
Width	660 mm	Inner Width	650 mm
Height	420 mm	Inner Height	430 mm

Technical Data

Type	RYTLE Load Carrier F21, basis for SOFTBOX Front	Length	650 mm
Load	30 kg	Width	570 mm